

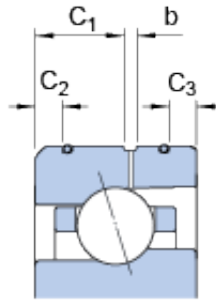

GQ BEARING PROCESSING LTD

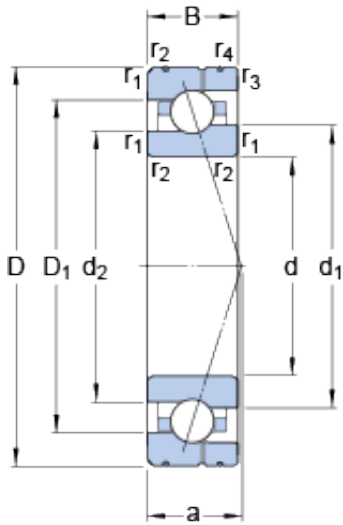

55 mm x 90 mm x 18 mm SKF 7011
ACE/HCP4AL angular contact ball bearings

Bearing No. 7011 ACE/HCP4AL

7011 ACE/HCP4AL Bearing 2D drawings and 3D CAD models

Size	90x55x18 mm
Bore Diameter	90 mm
Outer Diameter	55 mm
Width	18 mm
d	55 mm
D	90 mm
B	18 mm
d ₁	67.73 mm
d ₂	65.6 mm
D ₁	77.25 mm
b	2.4 mm
C ₁	9 mm
C ₂	3.4 mm
C ₃	3.4 mm
r _{1,2} - min.	1.1 mm
r _{3,4} - min.	0.6 mm
a	26.1 mm
d _a - min.	61 mm
d _b - min.	61 mm
D _a - max.	84 mm
D _b - max.	85.8 mm
r _a - max.	1 mm
r _b - max.	0.6 mm
d _n	69.6 mm



GQ BEARING PROCESSING LTD

Basic dynamic load rating - C	15.9 kN
Basic static load rating - C ₀	11.6 kN
Fatigue load limit - P _u	0.49 kN
Limiting speed for grease lubrication	23000 r/min
Limiting speed for oil lubrication	35000 mm/min
Ball - D _w	7.938 mm
Ball - z	24
G _{ref}	5 cm ³
Calculation factor - e	0.68
Calculation factor - Y ₂	0.87
Calculation factor - Y ₀	0.38
Calculation factor - X ₂	0.41
Calculation factor - Y ₁	0.92
Calculation factor - Y ₂	1.41
Calculation factor - Y ₀	0.76
Calculation factor - X ₂	0.67
Preload class A - G _A	140 N
Preload class B - G _B	430 N
Preload class C - G _C	860 N
Calculation factor - f	1.07
Calculation factor - f ₁	0.99
Calculation factor - f _{2A}	1
Calculation factor - f _{2B}	1.03
Calculation factor - f _{2C}	1.06
Calculation factor - f _{HC}	1.01
Preload class A	128 N/micron
Preload class B	193 N/micron



GQ BEARING PROCESSING LTD

Preload class C	251 N/micron
d_1	67.73 mm
d_2	65.6 mm
D_1	77.25 mm
C_1	9 mm
C_2	3.4 mm
C_3	3.4 mm
$r_{1,2}$ min.	1.1 mm
$r_{3,4}$ min.	0.6 mm
d_a min.	61 mm
d_b min.	61 mm
D_a max.	84 mm
D_b max.	85.8 mm
r_a max.	1 mm
r_b max.	0.6 mm
d_n	69.6 mm
Basic dynamic load rating C	15.9 kN
Basic static load rating C_0	11.6 kN
Fatigue load limit P_u	0.49 kN
Attainable speed for grease lubrication	23000 r/min
Attainable speed for oil-air lubrication	35000 r/min
Ball diameter D_w	7.938 mm
Number of balls z	24
Reference grease quantity G_{ref}	5 cm ³
Preload class A G_A	140 N
Static axial stiffness, preload class A	128 N/ μ m
Preload class B G_B	430 N
Static axial stiffness, preload class B	193 N/ μ m
Preload class C G_C	860 N



GQ BEARING PROCESSING LTD

Static axial stiffness, preload class C	251 N/ μ m
Calculation factor f	1.07
Calculation factor f_1	0.99
Calculation factor f_{2A}	1
Calculation factor f_{2B}	1.03
Calculation factor f_{2C}	1.06
Calculation factor f_{HC}	1.01
Calculation factor e	0.68
Calculation factor (single, tandem) Y_2	0.87
Calculation factor (single, tandem) Y_0	0.38
Calculation factor (single, tandem) X_2	0.41
Calculation factor (back-to-back, face-to-face) Y_1	0.92
Calculation factor (back-to-back, face-to-face) Y_2	1.41
Calculation factor (back-to-back, face-to-face) Y_0	0.76
Calculation factor (back-to-back, face-to-face) X_2	0.67
Mass bearing	0.36 kg